

SPECIFICATIONS are found on *Turbine Series introduction page*.

How to Order -The example below illustrates how the part numbers are constructed.

1000MA	P	10
<u>Basic Model</u> 180 GPH Add 'M' for metal bowl Example: 1000MAM	<u>Water Probe.</u> ¹ Add 'P' for an in-bowl water probe. (Omit if not desired).	<u>Element Filtration Rating.</u> Specify one: '2' for 2 micron '10' for 10 micron or '30' for 30 micron
¹ Must be used with Water Detection Kit. See Accessories Section.		

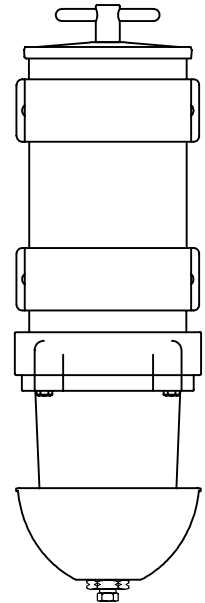

1000MA



Replacement Service Elements -For all Model 1000 Series
 SERVICE ELEMENT INCLUDES LID SEAL AND T-HANDLE O-RING.

2020SM-OR	2 Micron (Brown end caps) Recommended for Final /Secondary Filtration
2020TM-OR	10 Micron (Blue end caps) Recommended for Primary or Secondary Filtration
2020PM-OR	30 Micron (Red end caps) Recommended for Primary Filtration* Only. *A secondary/final filter is required downstream.

Mounting Hole Pattern -Refer to *Turbine Series introduction page* for filter dimensions.

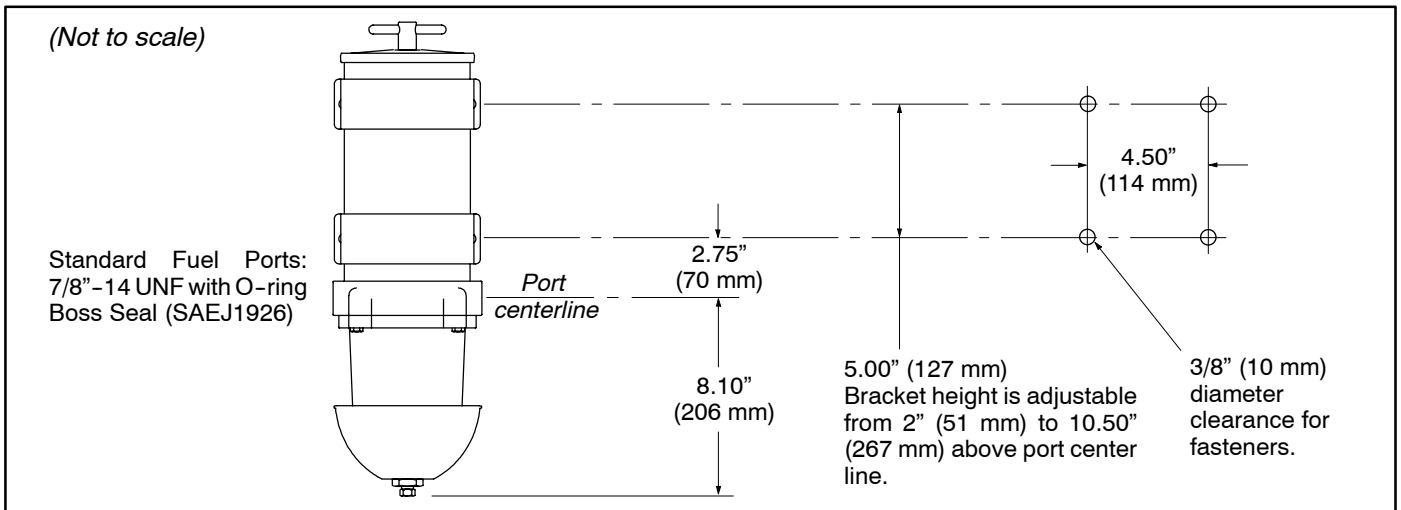

Performance Graphs -These results are from controlled laboratory tests. Field results may vary by application.

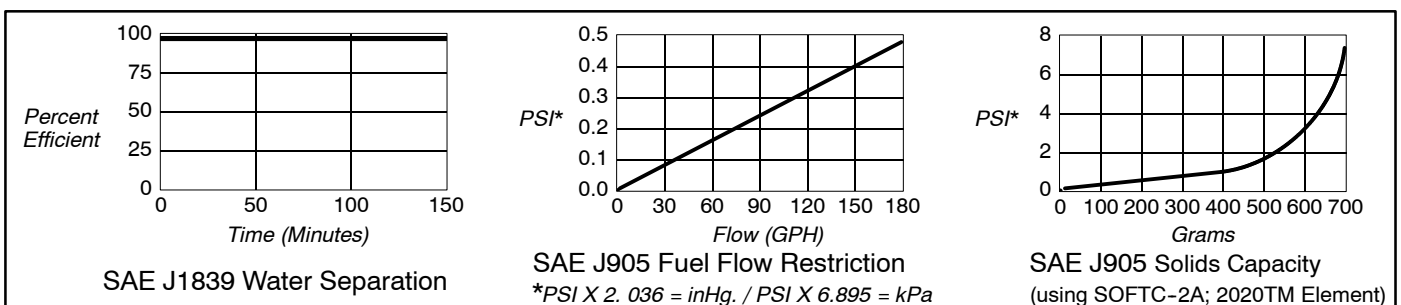
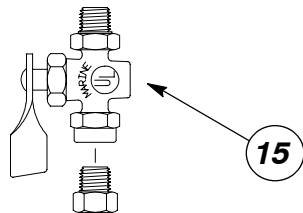
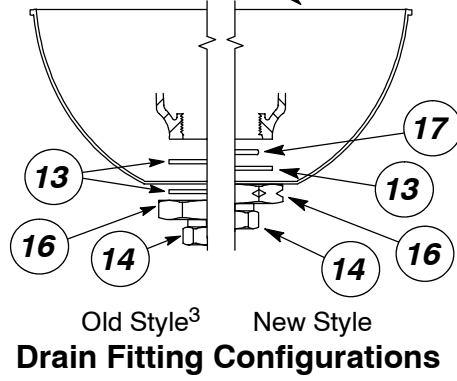
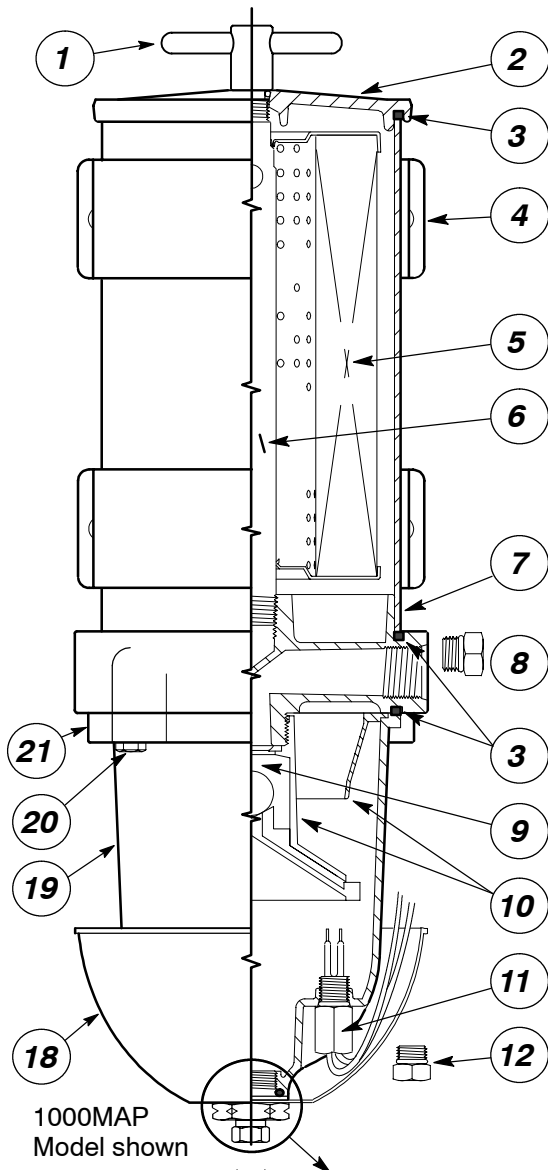

FIGURE 1. 1000MA Series Cutaway View. The circled number corresponds to the item number shown below.



Item	Part No.	Description	Case Qty.
1	RK11888	T-handle	1
	11350	T-handle O-ring	10
2	RK11005B	Lid	1
	RK11005B-02	Lid with Vent Port and Plug Kit (not shown)	1
3	11007	Square-cut Gasket (Lid & Bowl ring)	10
4	RK11815-101	Body Clamp Bracket	1
5	2020SMOR	2 Micron Element with Seals	12
	2020TMOR	10 Micron Element with Seals	12
	2020PMOR	30 Micron Element with Seals	12
6	RK11008	Return Tube (w/ tapered pipe body-end threads)	1
	RK11-1775	Return Tube (w/ straight body-end threads)	1
7	RK11021	Outer Cylinder	1
8	RK11-1679	Plastic Body Plug	1
9	RK11028B	Check Ball and Seal	10
10	RK11026D	Turbine Centrifuge / Conical Baffle	1
11	RK21069 ¹	Water Probe (MA Bowls)	1
12	RK20022	Metal Water Probe Port Plug	1
13	RK11341	Bowl Drain Gasket Kit (for New and Old Styles)	10
	11041	Bowl Drain Washer (New and Old Style)	1
14	918-N4	Bowl Plug, 1/4" NPT (New and Old Style)	1
15	RK19492	Shut-off Drain Valve Kit (for diesel use, only)	1
16	11-1910	Bowl Drain Fitting (New Style)	10
	RK11-1910	Complete Bowl Drain Fitting Kit (New Style)	1
	11040	Bowl Drain Washer (Old Style)	10
17	11340	Drain Fitting O-ring (New Style)	1
18	RK11868 ²	Heat Deflector Shield (MA)	1
19	RK11-1606-1	Clear Bowl with Water Probe Port	1
	RK11734	Metal Bowl (MAM -not shown)	1
	RK11734-01	Metal Bowl w/ 1/4"NPT Drain & Water Probe Port	1
20	RK11542	Hex/Washer Head Capscrew, 1/4"-20 x 1" (4)	1
21	RK11037A	Bowl Ring	1
22	RK11-1404	Seal Service Kit (all models- not shown)	1
	19466	Installation Instructions, 900/1000MA	

1 For diesel service only. Must be used with a Water Detection Kit.
 2 For replacement only. The Coast Guard does not accept 'FG' units converted to 'MA' configurations.
 3 Units built prior to Fall, 1998
 See Accessories Section.